

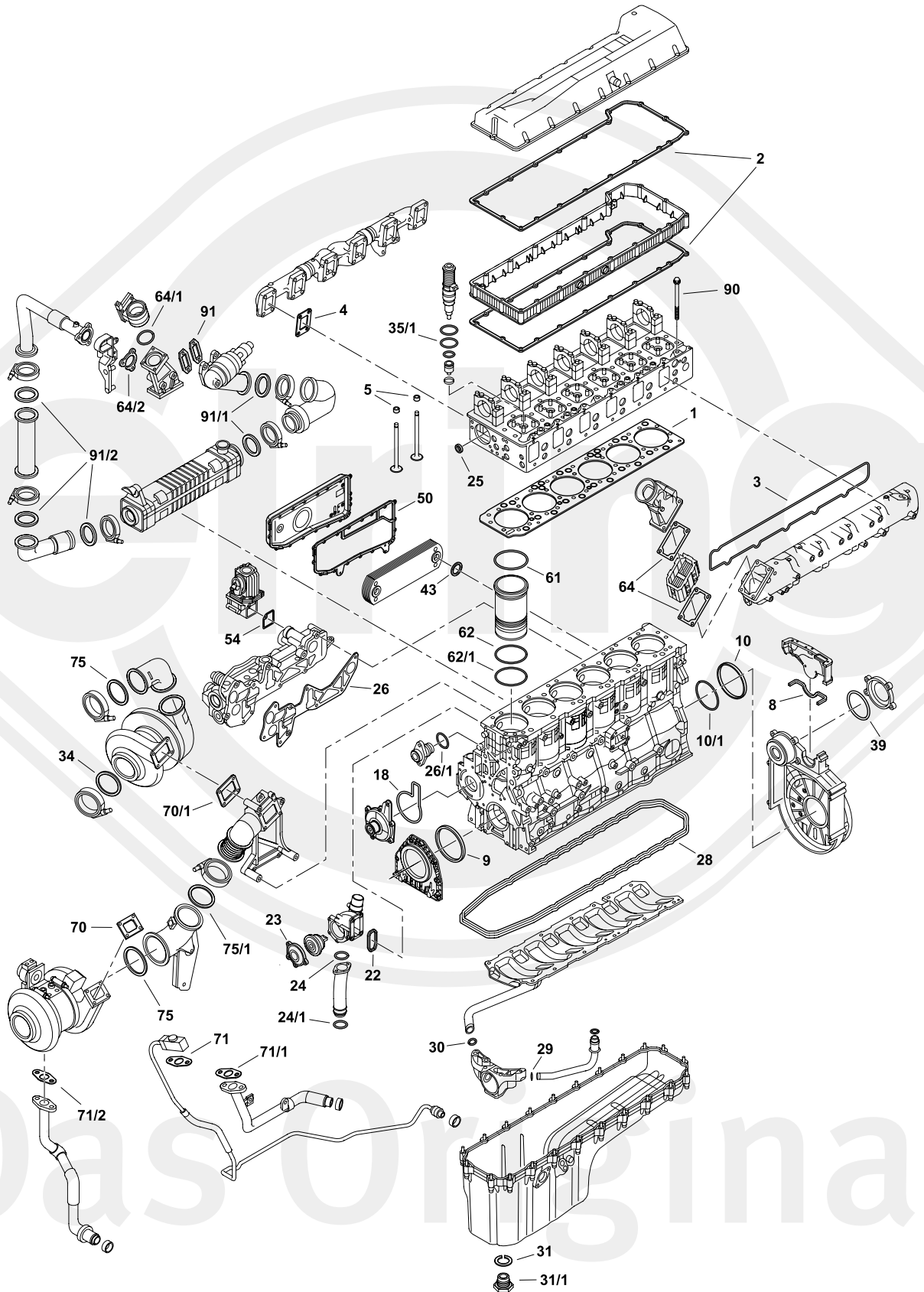

Das Original

Volvo

D 16 K





D 16 K



|        |   |     |                  |                           |  |
|--------|---|-----|------------------|---------------------------|--|
| ES ⊕   | 504.050   | 1x  | 22 415 644       | -                         | -  |
| CS*    | 504.100   | 1x  | 22 415 645       | -                         | -  |
| ZKS    | 964.550   | 1x  | 21 345 129 (38x) | M18x2,5x185               | -  |
| ZLBS   | 242.430   | 6x  | 20 520 607       | -                         | -  |
| EGR    | 506.420   | 1x  | -                | -                         | -  |
| TLS    | 837.780   | 1x  | -                | -                         | Bi-Turbo   |
|        |   |     |                  |                           |  |
| 1      | 542.300   | 1x  | 21 575 727       | -                         | -  |
| 2      | 487.490   | 2x  | 22 598 872       | -                         | -  |
| 3      | 994.060   | 1x  | 20 563 945       | -                         | -  |
| 4      | 541.273   | 6x  | 21 352 841       | -                         | -  |
| 5      | 125.771   | 24x | 20 924 435       | 10x12,4/16,2x9,5 FPM      | -  |
| 8      | 317.961   | 1x  | 20 815 558       | -                         | -  |
| 9      | 000.270   | 1x  | 21 347 087       | 136x159x13 AW RD PTFE/ACM | -  |
| 10     | 453.851   | 1x  | 20 441 481       | 180x205x15 AW LD PTFE/ACM | -  |
| 10     | 081.460   | 1x  | 1 543 896        | 180x205x15 AW LD FPM      | -  |
| 10 / 1 | -   | 1x  | 948 977          | 162x3 FPM RD              | -  |
| 18     | 313.130   | 1x  | 21 103 569       | -                         | -  |
| 22     | 744.950   | 1x  | 8 131 154        | -                         | -  |
| 23     |  | 1x  | 975 675          | 66x3 FPM RD               | -  |
| 24     | 907.000   | 1x  | 21 423 788       | -                         | -  |
| 24/1   | 980.830   | 1x  | 20 799 996       | -                         | -  |
| 25     |  | 2x  | 1 547 252        | -                         | -  |
| 26     | 100.954   | 1x  | 21 497 512       | -                         | -  |
| 26/1   |  | 1x  | 949 659          | 34,2x3 FPM RD             | -  |
| 28     | 265.310   | 1x  | 20 734 156       | Elastomer                 | -  |
| 29     | 550.770   | 2x  | 1 543 578        | 27,2x6 FPM RD             | -  |
| 30     |  | 2x  | 21 780 371       | -                         | -  |
| 31     | 729.590   | 1x  | 20 579 690       | 22,3x33x2 FE/FPM          | -  |
| 31/1   | 996.820   | 1x  | 20 571 854       | -                         |  |
| 34     |  | 1x  | 1 638 168        | -                         | -  |
| 35/1   | 369.521   | 6x  | 276 948          | -                         | set  |



D 16 K

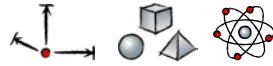

|        |   |     |            |                  |   |
|--------|---|-----|------------|------------------|---|
| 39     | 846.580   | 1x  | 976 068    | 164,3x5,7 FPM RD | - |
| 43     | 390.190   | 2x  | 20 551 483 | -                | - |
| 50     | 712.850   | 1x  | 21 302 234 | -                | - |
| 54     | 767.500   | 1x  | 20 532 891 | -                | - |
| 61     |    | 6x  | 8 131 248  | 151x5 EPDM RD    | - |
| 62     |    | 6x  | 1 543 501  | 154x2,4 FPM RD   | - |
| 62 / 1 |    | 6x  | 8 131 249  | 151x5 FPM RD     | - |
| 64     | 390.270   | 2x  | 3 979 639  | -                | - |
| 64/1   |    | 1x  | 948 980    | 89,5x3 ACM RD    | - |
| 64/2   | 750.280   | 1x  | 21 724 572 | -                | - |
| 70     | 310.020   | 1x  | 22 384 418 | -                | - |
| 70/1   | 753.238   | 1x  | 20 784 537 | -                | - |
| 71     |  | 1x  | 21 206 133 | -                | - |
| 71/1   | 904.930   | 1x  | 21 875 781 | -                | - |
| 71/2   |  | 1x  | 20 707 685 | -                | - |
| 75     | 451.600   | 2x  | 21 045 603 | -                | - |
| 75/1   | 031.440   | 1x  | 21 895 636 | -                | - |
| 90     | 964.550   | 38x | 21 345 129 | M18x2,5x185      | - |
| 91     | 369.120   | 1x  | 20 850 815 | -                | - |
| 91/1   |  | 2x  | 20 841 816 | -                | - |
| 91/2   |  | 3x  | 967 343    | 64,5x3 FPM RD    | - |